

HWP100

The HWP Pump is available in AC or DC power options and offers single head only. An assortment of plunger sizes combined with TXAM's pump controller will allow you to precisely control your injection rates.

The HWP Series isolates chemicals away from the pump housing and motor. Standard stainless steel wetted parts are used to ensure long lasting dependability.

TXAM combines innovative pump design with the power of solar energy to produce an environmentally friendly, maintenance free pumping solution made to last. This model is also available in AC power for areas with low sunlight.



Specifications

Pump

Fluid Head

- Single
- Stainless Steel (Standard) or other material

Plunger

- 1/4", 3/8"
- 17-4 PH, optional ceramic coating
- 1-Position non-adjustable displacement

Gear Motor

- 12VDC, 3.8 AMP, 1/25 HP, 43 RPM
- 115VAC, .45 AMP, 1/30 HP, 60 Hz, 28 RPM, 1 PH

Connections

- 1/4" Female NPT

Bleeder Valve

- 316SS, located on head

Power Option(s)

Solar / DC or Electric / AC

- 12VDC
- 115VAC

Solar

- 50, 80, 110, or 130 Watt

Battery

- 6 or 12VDC (Sized per application)
- AGM or lead acid (Standard)

Pump Control

Control Options

- TXAM Controller options
- Flow Control Valve (FCV5000)
- 4-20mA, RS-232, RS-485, Modbus

ZERO Venting of Gas
LOW Cost of Ownership
FAST Return On Investment

Max Pressure: 1500 PSI/100 Bar
0 GPD to (6.5 GPD -DC) (20 GPD -AC)

* Single head configuration

* Only single head option available

* Stainless Steel head assembly

* Stainless Steel pump housing

* Multiple rate control operations within one pump controller

* One plunger stroke length

* Non-adjustable packing

HWP100

Plunger Sizes	1/4"	3/8"
Stroke Length	1.0"	1.0"
Minimum Flow Rate DC	0.57 QPD	1.2 QPD
Maximum Flow Rate DC	7.7 GPD	17.2 GPD
Minimum Flow Rate AC	0.85 QPD	1.9 QPD
Maximum Flow Rate AC	11.5 GPD	25.9 GPD
Max Pressure (PSIG)	1500	725
Power Option(s)	12VDC / 115VAC	

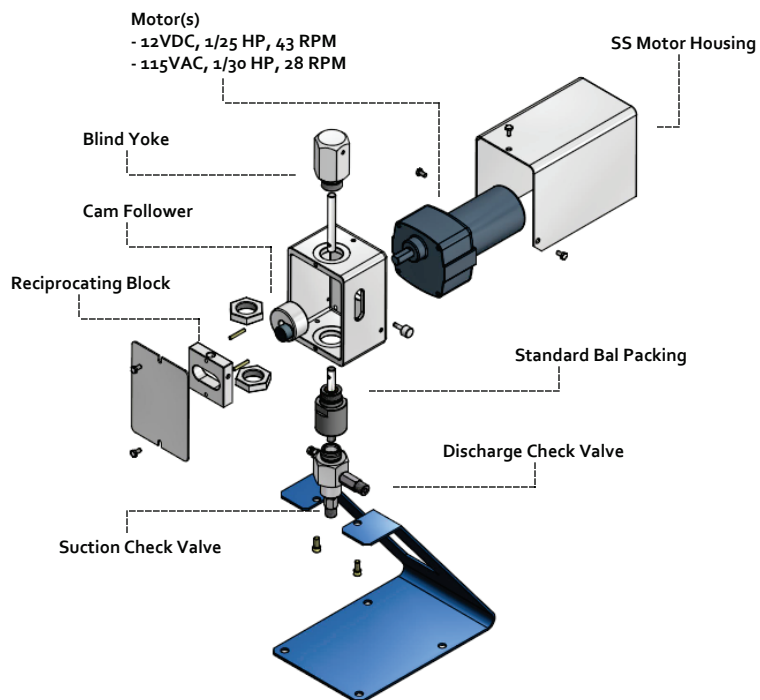

Dimensions

