

# PTP3500 & 6500

The PTP 6500 pneumatic pump is available in single head only. An assortment of plunger sizes, stroke adjustment screw, and motor speed control are utilized to precisely control your injection rates.

The PTP Series Pump is stainless steel construction for corrosion resistance. The stroke speed adjustments can be easily made by turning the built-in stroke adjustment screw. The turn down ratio allows for extremely low to the highest achievable dosing. Recommended supply pressures range from 50 -70 PSI.



## Specifications

### Pump

#### Fluid Head

- Single
- Stainless Steel (Standard) or other material

#### Plunger

- 3/8" @ 3500 PSI & 30 GPD
- 1/4" @ 6500 PSI & 12 GPD
- 17-4 PH
- Adjustable Stroke Length

#### Motor

- Optimal Supply Pressure: 50-70 PSI
- Max Pressure Range: 150 PSI
- SPM: 2-60

#### Connections

- 1/4" Female NPT

#### Bleeder Valve

- 316SS, located on head

### Power Option(s)

#### Pneumatic / Air / Gas

- Supplied / Compressed Air
- Natural / Raw Gas

### Pump Controller

#### Control Options

- Pneumatic Timer
- Pneumatic Solenoid
- 4-20mA (Automated Injection Rate Change)

**LOW Gas Emissions**

**LOW Cost of Ownership**

**FAST Return On Investment**

**Max Pressure: 6500 PSI/448 Bar**

**0 GPD to 30 GPD**

\* Single head configuration

\* Pumps only one chemical at a set rate

\* Stainless Steel head assembly

\* Stainless Steel pump body

\* Single rate control via pneumatic timer

\* Built in stroke length adjustment

\* Non-adjustable two piece packing

# PTP3500 & 6500

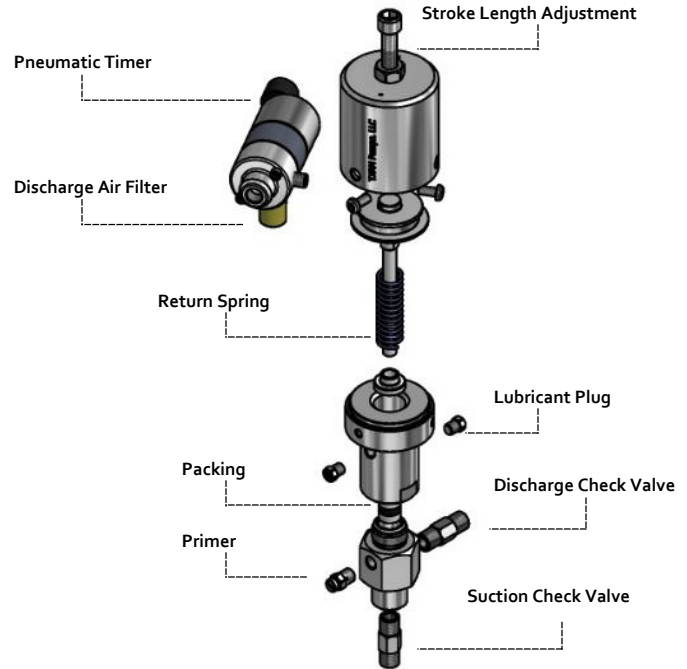

## Dimensions

